

Electric New Construction Application—Commercial



Kingman: Ph: 928-681-8922 Fax: 928-681-8920
2498 Airway Ave, Kingman, AZ 86409

Lake Havasu: Ph: 928-505-7016 Fax: 928-505-7032
2749 Maricopa Ave, Lake Havasu City, AZ 86406

Nogales: Ph: 520-761-7951 Fax: 520-761-7947
861 W Mariposa Rd, Nogales, AZ 85621
Toll Free: 877-UES-4YOU (837-4968)

Applicant Information

Business Name _____ C/O _____

Owner/Financially Responsible Party _____

Work Phone _____ Message Phone _____

Cell Phone _____ E-Mail Address _____

Mailing Address _____ City _____ State _____ Zip _____

Billing Address _____ City _____ State _____ Zip _____

Date (estimate) when power is needed: Month _____ Day _____ Year _____

Business Information

Partnership Corporation Sole Owner Other: _____

Tax ID No _____ Type of Business _____

Service Location Information

Service Address _____ Cross Street _____ City _____ Zip _____

Legal Description:

Tract ___ Block ___ Lot ___ Subdivision _____ Township ___ Range ___ Section ___ City County

Parcel No: (Example: 310-06-025) _____

AMPS: 100 200 Other: _____

If structure is a manufactured building, date it will be moved into: _____

Square Footage _____ Voltage _____

Type of Service:

- | | | |
|---|---|--------------------------------------|
| <input type="checkbox"/> Permanent | <input type="checkbox"/> Dusk to Dawn Light | <input type="checkbox"/> Underground |
| <input type="checkbox"/> Temporary Construction | <input type="checkbox"/> Single Phase | <input type="checkbox"/> Overhead |
| <input type="checkbox"/> Service Upgrade | <input type="checkbox"/> Three Phase | |

Note: The commercial temporary construction fee will be determined by the Engineering Department. Other rules and fees may apply according to the Rules and Regulations approved by the Arizona Corporation Commission. "Electric Service Installation Requirements" booklets available online at www.uesaz.com, by mail, or in the local office. All services must meet E.U.S.E.R.C. (Electric Utility Service Equipment Requirements Committee) standards.

Builder _____ Phone _____

Electrician _____ Phone _____

Note: UniSource requires the Applicant to complete this Application and submit a site plan and electrical load requirements. The Applicant is responsible for notifying UniSource when service pole or service entrance is installed and ready for service (City, County and/or State Inspections may be required prior to connection). A security deposit is required, and the amount will be determined prior to meter set. In lieu of a deposit, a Surety Bond may be submitted.

Signature _____ Date Requested _____

UniSource Energy Services Plot Plan



Legal Description: Township _____ Range _____ Section _____
Subdivision _____
Block _____ Lot _____ Parcel _____
Address _____

Please enter the following information:

1. Property boundary dimensions, dimensions of all existing and proposed structures, and distances between all buildings.
2. Location of public utility easement(s).
3. Location of septic tank(s) and leach field(s).
4. Location of proposed service entrance.

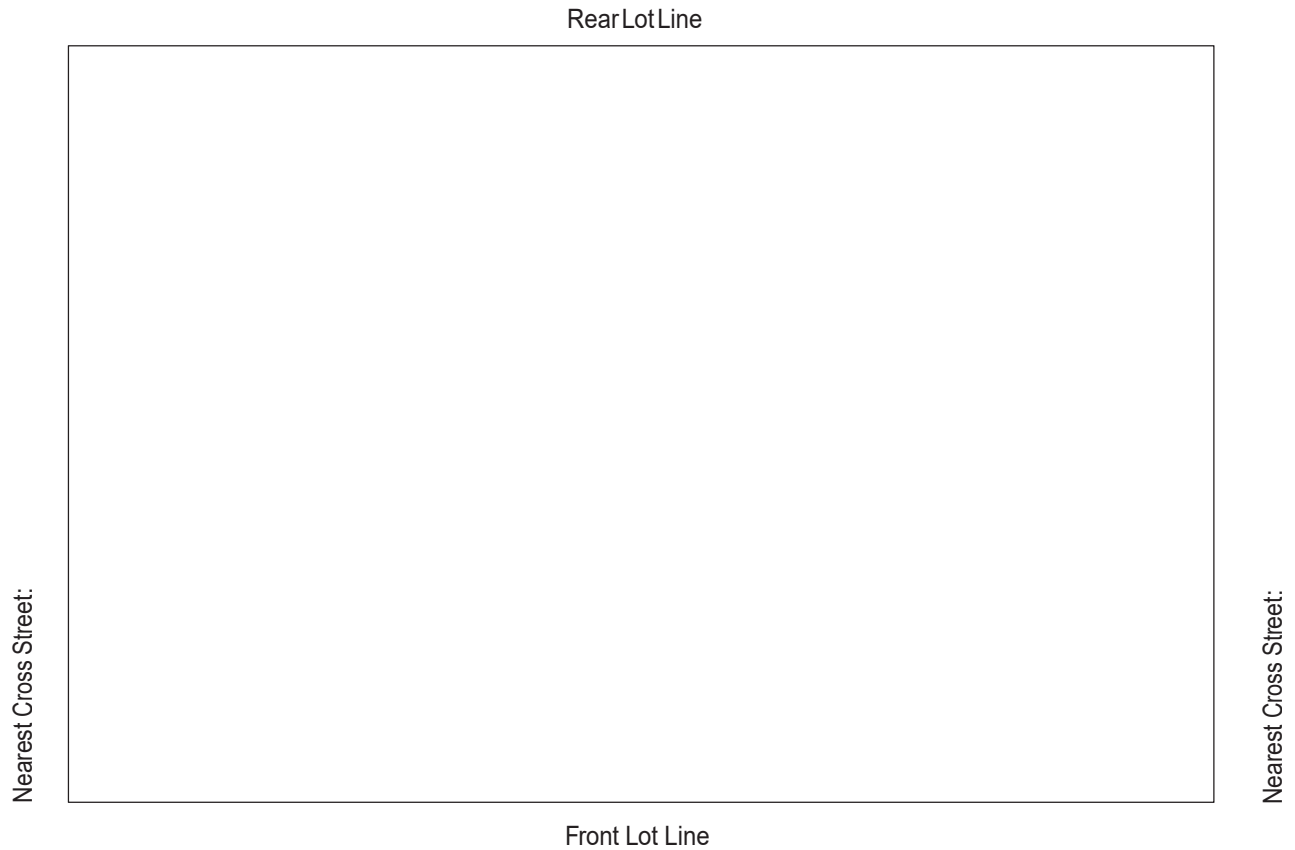

Front Street

Indicate North:

UniSource Energy Services Plot Plan Example

Legal Description: Township 10N Range 10W Section 10
Subdivision Sunny Arizona Ranchos, Unit 10
Block 10 Lot 10 Parcel 111-22-333
Address 1010 Your Property Street

Please enter the following information:

1. Property boundary dimensions, dimensions of all existing and proposed structures, and distances between all buildings.
2. Location of public utility easement(s).
3. Location of septic tank(s) and leach field(s).
4. Location of proposed service entrance.

