



COMMERCIAL APPLICATION FOR NEW GAS SERVICE
Requiring Construction

www.uesaz.com

1-877-837-4968

SERVICE ADDRESS

Lot # City

CUSTOMER INFORMATION

Mailing Address Same as Service Address

Company Name

Name of Owner

Sole Proprietor

Partnership

Incorporated

Tax ID #

Contact Name

Contact Phone

Cell

Billing Address

City

State

Zip

Business Phone (Day)

Cell

Evening

email

Driver's Lic #

State Licensed

Emergency Contact

Emergency Contact Phone

NATURAL GAS APPLIANCE INFORMATION - list all appliances that will be on natural gas (new or converted) *

BTU load

Qty

Total

Boiler

Furnace

RTU (Roof-Top Unit)

Water Heater

Dryer

Total of all other *

***Please provide remaining cumulative total connected load and attach applicable documentation**

Total Load

Single

Multi-Unit

of Units

UniSource to provide trench - \$22.50 per foot

EFV - \$141.00

Customer/Contractor to provide trench - \$16.50 per foot *

Contractor Name

Contractor Phone

* Trench to be provided in accordance with UniSource Energy Services standards. Trench details are available.

UNS Gas standard delivery pressure is 7" water column (0.25 psig). Prior approval from UNS Gas Engineering is required if greater pressure is requested.

As of April 14, 2017, the Department of Transportation code requires the installation of an Excess Flow Valve (EFV) on service lines of all single family residence, multi-family and single, small commercial facilities. You will be billed \$141.00 in addition to the cost of the service line as listed above.

Date building to be framed:

By signing below, I attest that I have read, agree and have accurately completed the items on both pages of this document, and that I have the authority to grant UniSource Energy Services an easement and right-of-way to ensure proper service connection & maintenance, and that I am responsible for the construction charges.

Customer Signature

Date signed:

PLEASE READ CAREFULLY

General Conditions:

- The Company will in all cases be responsible for construction of the service line from the Company’s distribution main to the customer’s property line for an amount not to exceed the Incremental Contribution Study; the customer will pay the Company for the difference. The customer will pay the Company for the gas service line on the customer’s property at a rate of **twenty-two dollars and 50 cents (\$22.50) per foot**. For customers who provide the trench for the entire service line in accordance with Company standards, the customer will pay the company at a rate of **sixteen dollars and 50 cents (\$16.50) per foot**.
- The customer, at the customer’s own expense, shall furnish and install all other pipe fittings and connections between the point of delivery and each point of consumption.
- UniSource Energy Services personnel will stake the meter location and estimate the cost of the service line installation (including any feasibility study credit for the connection from the main to customer’s property line). Customer will be contacted with the cost and payment is due prior to scheduling installation. Once the service line is installed, the final cost will be compared to the estimate and the customer will be billed or refunded any difference.
- The meter set assembly (MSA) must be located within three feet of the front corner of the building, unless otherwise approved by UniSource Energy Services. The MSA must also be three feet spherically from windows, doors, vents, electric boxes, telephone boxes, cable boxes, drip system timers and AC units. The meter must not be fenced in, covered, or enclosed in any other manner.
- Ground wires must not be attached to UniSource Energy Services gas piping. Do not pour concrete around gas riser without Company approved sleeving.
- UniSource Energy Services will not provide gas service to customer premises with copper pipe or tubing.

Customer Responsibilities:

- **Return this completed and signed document.**
- **Construction, installation and maintenance downstream of the meter.**
- **Notify UniSource Energy Services when the house is framed or mobile home set up.**
- **Removing and replacing customer owned landscaping, asphalt or concrete before and after installation of the service line.**
- **Having the lot at final grade – any alterations will be at customer's expense.**
- **Inform the Company or its contractor, under Arizona Underground Facility Law (Arizona 811), of the location of any underground facility in its property that is not otherwise marked by the underground facility owner – (i.e. sprinkler systems, driveway lights, septic tanks, leach fields etc.)**
- **Connect to natural gas within 4 months of gas availability.**
- **This application may be mailed, dropped, email or faxed to the appropriate locations below:**

<u>Email</u>	<u>Mailing Address</u>	<u>Phone</u>	<u>Fax</u>
<i>Flagstaff, Williams, Ash Fork & Seligman</i>			
FlagConst@uesaz.com	1459 E Butler Ave, Flagstaff, 86001	928 525-8182	928 779-1272
<i>Kingman</i>			
KingConst@uesaz.com	3436 N Evans St, Kingman, 86401	928 681-6503	928 681-6505
<i>Lake Havasu City</i>			
HavasConst@uesaz.com	2749 Maricopa Ave, Lake Havasu City, 86406	928 505-7018	928 854-5052
<i>Prescott, Prescott Valley, Chino Valley, Mayer, Spring Valley & Black Canyon City</i>			
PresConst@uesaz.com	6405 N Wilkinson Dr, Prescott, 86301	928 771-7272	928 717-1794
<i>Show Low, Pinetop/Lakeside, Snowflake, Taylor, Holbrook, Joseph City, Winslow</i>			
ShowLowConst@uesaz.com	1480 N 16th St, Show Low, 85901	928 532-3870	928 537-3994
<i>Cottonwood, Sedona, Village of Oak Creek, Clarkdale, Jerome, Camp Verde</i>			
VerdeConst@uesaz.com	500 S Willard St, Cottonwood, 86326	928 203-1270	928 634-8994
<i>Nogales, Rio Rico, Tubac, Amado, Patagonia</i>			
SantaCruzConst@uesaz.com	861 W Mariposa Rd, Nogales, 85621	520 761-7950	520 761-7947

SERVICE LINE CONSTRUCTION

For UniSource Use Only, Please return with the application

SERVICE ADDRESS CITY

LOT # SUBDIVISION

NEAREST CROSS STREET

CUSTOMER NAME CELL PHONE

EMAIL CONTACT PHONE

PROPERTY LINE SET METER SET ONLY TRENCH PROVIDED DATE READY

CONTRACTOR NAME CONTRACTOR PHONE

MAIN STEEL PE SHORT SIDE LONG SIDE EXISTING STUB ASPHALT CUT

ADJACENT ADDRESS BTU LOAD

EXISTING EFV SIZE & MATERIAL SERIES

FOOTAGE: MAIN TO P/L P/L TO STAKE CUSTOMER PIPING YES NO

DISTANCE TO CORNER OF HOUSE DISTANCE FROM CUSTOMER PIPING

NEW EFV/MSV SIZE & MATERIAL SERIES

DATE STAKED STAKED BY

AMOUNT BILLED INVOICE NUMBER

DATE MAILED TO CUSTOMER EMAIL MAIL DATE PAID

DATE TO CREW

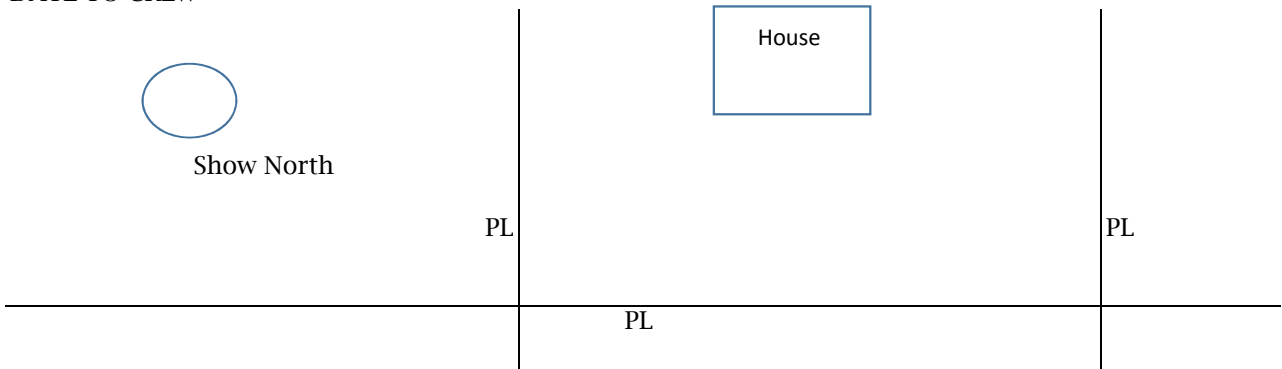

COMMENTS: